

- NOTES**
1. CONTAINMENT MOUNTED ABOVE SUSPENDED CEILINGS SHALL BE MOUNTED 'FACE UP' ON SUITABLE BRACKETRY.
 2. MANUFACTURERS APPROVED FIXING BRACKETS SHALL BE USED THROUGHOUT, OBSERVING RECOMMENDED SPACINGS.
 3. USE MANUFACTURERS PRE-FABRICATED BENDS AND ANGLE PIECES AT ALL TIMES.
 4. CONTAINMENT SIZES AS SHOWN ON LEGEND UNLESS OTHERWISE INDICATED ON THE DRAWING.
 5. LIASE WITH HVAC ENGINEER AT START OF PROJECT TO ENSURE CO-ORDINATION BETWEEN SERVICES.
 6. CONTAINMENT SHALL BE INSTALLED AT HIGH LEVEL ABOVE THE SUSPENDED CEILING. NO CONTAINMENT SHALL FOUL LUMINAIRES. IF THEY DO, THE CONTAINMENT SHALL BE REMOVED, RE-ROUTED AND RE-INSTALLED AT CONTRACTORS COST.
 7. WHERE CONTAINMENT PASSES THROUGH WALLS, FIRE RATED PARTITIONS, OR COMPARTMENTS, THE CONTRACTOR SHALL ALLOW FOR ALL PENETRATIONS TO BE SEALED TO THE SAME FIRE RATING AS THE WALL/PARTITION THEY PASS THROUGH. TRUNKING SHALL ALSO HAVE FIRE RATED INTUMESCENT MATERIAL INSTALLED WITHIN THE TRUNKING, AFTER ALL CABLING HAS BEEN INSTALLED.
 8. ALL CONTAINMENT SHALL HAVE EARTH LINKS AT JOINS.

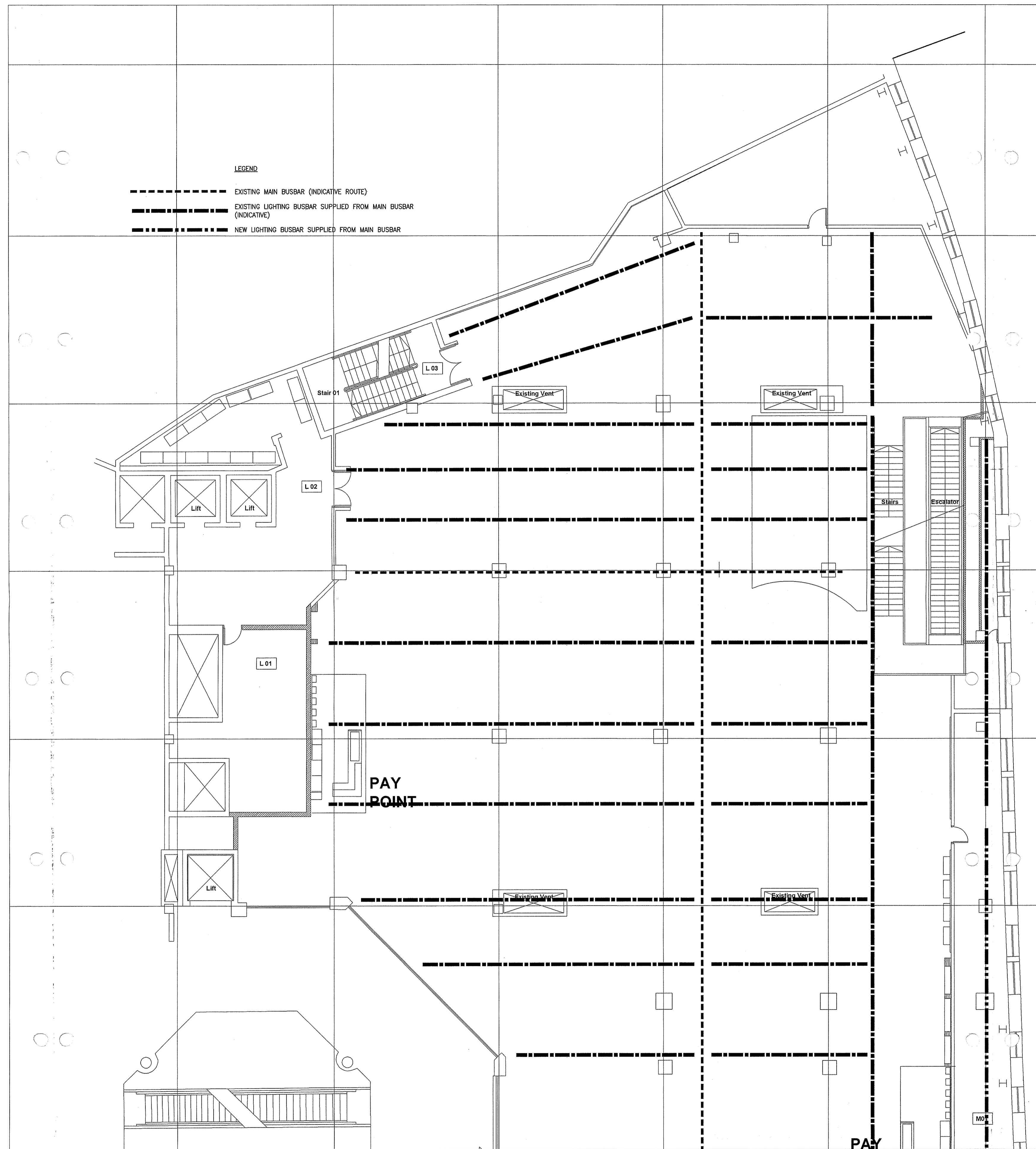

Services information only to be taken from this drawing. Not to be scaled

REV	DESCRIPTION	CHK	DATE
A	REVISED TO NEW LAYOUT		Feb '17

Project:
CO-OP REFURBISHMENT
PAISLEY

Services:
PROPOSED CONTAINMENT
LAYOUT
LEVEL 3 (PART 2 OF 2)

Originator : IS Scale : 1:100@A1
Checked : JL Date : OCTOBER 2016

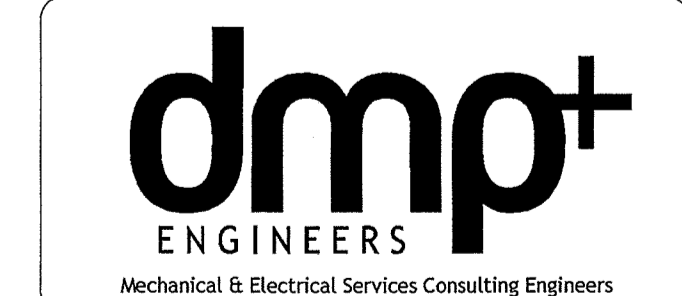

21-23 Blairtummock Place
Panorama Business Village
Glasgow G33 4EN
Tel: 0141 773 6820
Fax: 0141 773 6849
Email: glasgow@dmpengineers.co.uk

CONSTRUCTION

- NOTES**
1. CONTAINMENT MOUNTED ABOVE SUSPENDED CEILINGS SHALL BE MOUNTED 'FACE UP' ON SUITABLE BRACKETRY.
 2. MANUFACTURERS APPROVED FIXING BRACKETS SHALL BE USED THROUGHOUT, OBSERVING RECOMMENDED SPACINGS.
 3. USE MANUFACTURERS PRE-FABRICATED BENDS AND ANGLE PIECES AT ALL TIMES.
 4. CONTAINMENT SIZES AS SHOWN ON LEGEND UNLESS OTHERWISE INDICATED ON THE DRAWING.
 5. LIASE WITH HVAC ENGINEER AT START OF PROJECT TO ENSURE CO-ORDINATION BETWEEN SERVICES.
 6. CONTAINMENT SHALL BE INSTALLED AT HIGH LEVEL ABOVE THE SUSPENDED CEILING. NO CONTAINMENT SHALL FOUL LUMINAIRES. IF THEY DO, THE CONTAINMENT SHALL BE REMOVED, RE-ROUTED AND RE-INSTALLED AT CONTRACTORS COST.
 7. WHERE CONTAINMENT PASSES THROUGH WALLS, FIRE RATED PARTITIONS, OR COMPARTMENTS, THE CONTRACTOR SHALL ALLOW FOR ALL PENETRATIONS TO BE SEALED TO THE SAME FIRE RATING AS THE WALL/PARTITION THEY PASS THROUGH. TRUNKING SHALL ALSO HAVE FIRE RATED INTUMESCENT MATERIAL INSTALLED WITHIN THE TRUNKING, AFTER ALL CABLING HAS BEEN INSTALLED.
 8. ALL CONTAINMENT SHALL HAVE EARTH LINKS AT JOINS.

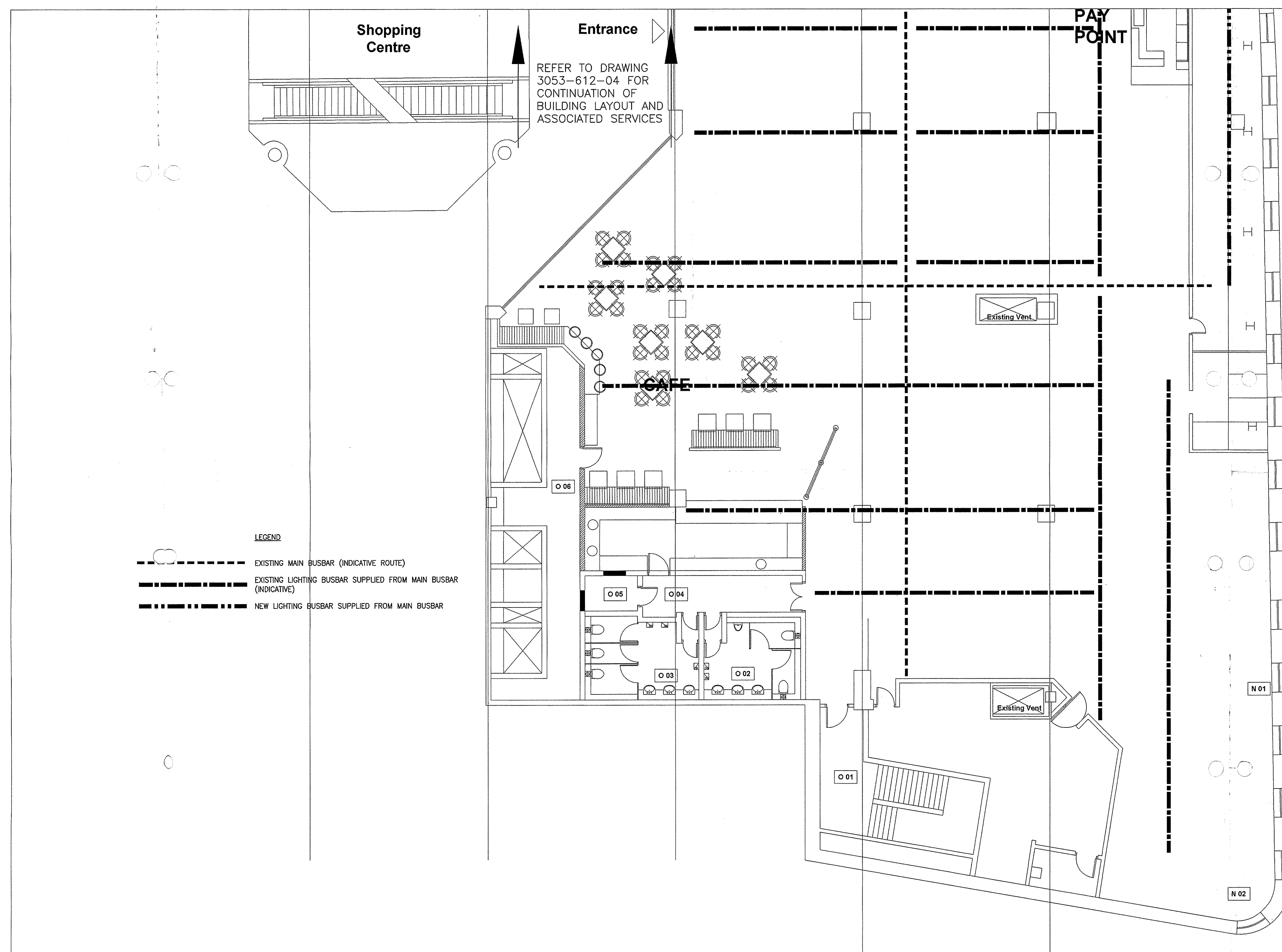

REV	DESCRIPTION	CHK	DATE
A	REVISED TO NEW LAYOUT	CHK	Feb '17

Project:
CO-OP REFURBISHMENT PAISLEY

Services:
PROPOSED CONTAINMENT LAYOUT LEVEL 3 (PART 1 OF 2)

Originator: JS Scale: 1:1000A1
Checked: JL Date: OCTOBER 2016

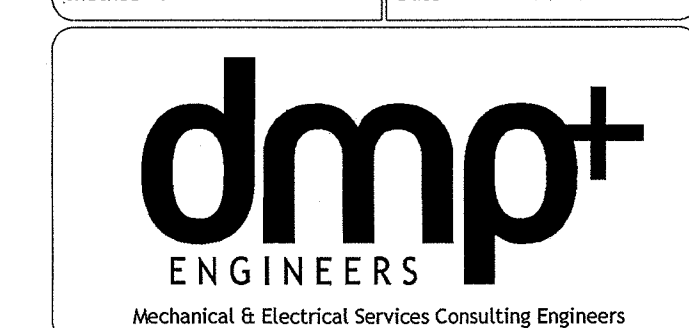

21-23 Blairtummock Place
Panorama Business Village Glasgow G33 4EN
Tel: 0141 773 6820 Fax: 0141 773 6849
Email: glasgow@dmpengineers.co.uk

CONSTRUCTION